



Communicate & Collaborate with Sharp

Explore our range of AV furniture, height adjustable & mobile AV stands and digital signage stands.

www.sharp.co.uk

SHARP
Be Original.



The evolving workplace

Giving your employees the tools to collaborate effectively from wherever they are is more important than ever.

The workplace is constantly evolving, and so are the attitudes of the UK workforce – businesses need to be ready to adapt as things evolve. Hybrid or agile working is now desired and expected, employees want a blend of home and office working to fit in with their busy lives and improve their work life balance.

Done right, agile working policies can help staff feel their work-life is in their control, increase job satisfaction and productivity, and aid with staff retention. More motivated employees means greater customer satisfaction - and better bottom line profit.

Employers can look at making policy changes to include things like remote working, flexible hours, and more annual leave allowance. This would make each job role more varied and interesting for workers by encouraging the fair division or sharing of tasks.

The most important way an organisation can create a more flexible or dynamic working environment is by reviewing their available space, and by using technology. Dedicated collaboration space with the latest technology can keep people connected and the workforce productive and agile.





Your workspace re-imagined with our range of AV furniture

In a world where our working environments keep changing, choose a solution that can evolve with your requirements.

Instant collaboration with Collaborate 3, 5, and 7

Simply plug in your device or connect it via wireless and start your meeting - it's that easy.

Our Collaborate table range comes complete with a Sharp screen, so you can kick your important meetings off with ease. The solution offers space for collaboration and teamwork, integrated cables for connectivity, and additional power sockets located in the front leg for use by multiple users, allowing your teams to work together seamlessly and instantly.

As agile as your workforce

Today's workforce wants agility. Our collaborate range can be tailored to meet the demands of your people. Available as a 3, 5, or 7 seated solution, the size of the table can be selected to address your specific requirements.

You can also select the specification of your screens, video conferencing cameras, wireless connectivity, media players and audio equipment.

Integrated cables run from the screen to the cable cubby too, providing quick and easy connectivity as needed.

Use your space the smart way

Sharp's new solution gives you the flexibility to work independently or collaborate as a group, either physically at the table or remotely via integrated video conferencing technology. Collaborate 3, 5, and 7 are free standing, so there are no hardfixed furnishings to remove or replace - it can be reconfigured to create practical spaces whenever, wherever and however you need them.

Work your way with our height adjustable & mobile AV stands.

Our needs evolve all the time - and so too should our workspace.

Mobility

Our working needs are complex, and shouldn't be confined to a single space. Workplace technology needs to be versatile and highly mobile so that we can work anywhere in the office, at any time, as needed.

Sharp's new range includes the 'Switch 45' and 'Levigator' stand. Complete with the latest in Sharp's digital interactive display technology, the stands can be moved with ease thanks to their wheel based and easy locking system. So you can take the technology where it's needed.

Adaptability

Whatever your requirement, both Switch 45 and Levigator are highly adaptable and can be used in a multitude of ways. Whether you need a free standing screen in a meeting room, a work tool to aid with collaboration, or a digital signage display or way-finder, our new range has you covered.

The displays can be electronically adjusted in height so that you can bring the content to your level. The Switch 45 offers additional 45 degree tilt functionality for ease of use and the perfect view when collaborating.

Enhance your workspace with superior quality

Switch 45 and Levigator come complete with a 65" 4K ultra HD interactive display - so you no longer need to compromise on quality to gain mobility.

These stands deliver on all the features and quality you've come to expect from Sharp - the out of the box solution is simple and easy to use, with a pen and pen software included as standard, so you can collaborate and work together instantly.

Simply power up and you're away

Meetings can crop up quickly and leave little room to prepare or set up devices. With Switch 45 and Levigator all you need to ensure your solution is ready is a power outlet. Plug in your laptop, power up, and you're away. The screens come with wireless connectivity built in too - so sharing content is easier than ever.



Optimised
Workflow



Human Error is reduced

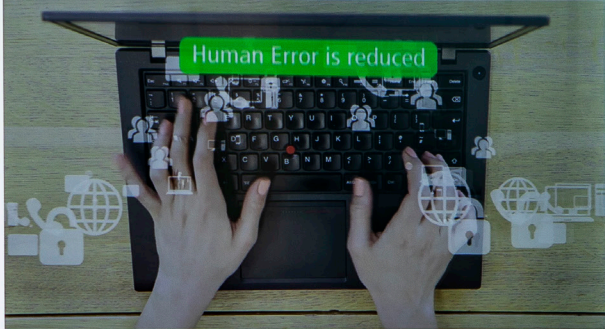

SHARP
Be Original.



Stand up and stand out.

Our latest digital signage solutions can help your organisation with important communications and making a great first impression.

Enhance and impress

Sharp's 55" or 65" professional displays integrate seamlessly with our new digital signage stands to bring you superior picture quality and crystal clear resolution - so you can stand out from the crowd.

The elegant stand also has room to house any other technologies that maybe required, such as a small form factor PC. All cabling is discreetly hidden within the stand to keep your space looking neat and tidy - a small cable exit at the bottom of the stand let's you plug in and go.

Your content, your way

In an increasingly agile world and workplace your content shouldn't be confined and limited to a set location.

Both the 65" and 55" digital signage stands are available in either landscape or portrait, so you can display your content your way.

Join the digital revolution

Digital signage has exploded in popularity in recent years because of its lasting impact. It is now a major part of advertising, work, and everyday life.

This innovative technology is used for visual signage, as way finders with maps and floor plans, and as a key form of internal and external communication. It provides a dynamic and impressive communication platform for any organisation.

Freedom to choose

Whether you're raising awareness of your latest sales promotion, or simply welcoming guests with tailored messages, Sharp's new digital signage solutions get your content up and running in no time.

Both the 65" and 55" landscape and portrait stands are freestanding with no hard fixings, so you aren't tethered to a single location. This means both stands can be moved and positioned in the most convenient and suitable location for you, with ease.

Collaborate 3,5 & 7

AV Furniture



Collaborate 3

Desk height collaborative table

Dimensions:

1440mm(W) x 1377mm(D) x 1541mm(H)

Weight: 80kg

Double Power socket on front leg

Compatible cables running from screen to cable

Cubby on table top top

Screen - PNHW431

Panel Technology TFT LCD

Native Resolution 4K UHD

Aspect Ratio 16:9

Backlight Technology LED / Full

Array Brightness (cd/m2) 350

Contrast Ratio 4000 : 1

Built in Speakers (W) 10W + 10W

Cabinet Colour Black



Collaborate 5

Desk height collaborative table

Dimensions:

1440mm(W) x 2271mm(D) x 1541mm(H)

Weight: 96kg

Double Power socket on front leg

Compatible cables running from screen to cable

Cubby on table top top

Screen - PN-HW501

Panel Technology LCD Native

Resolution 4K HD

Aspect Ratio 16:9

Backlight Technology W-LED / Full

Array Brightness (cd/m2) 350

Contrast Ratio 4000 : 1

Built in Speakers (W) 10W + 10W

Cabinet Colour Black



Collaborate 7

Desk height collaborative table

Dimensions:

1440mm(W) x 2680mm(D) x 1541mm(H)

Weight: 125kg

Double Power socket on front leg

Compatible cables running from screen to cable

Cubby on table top top

Screen - PN-HW551

Panel Technology TFT LCD Native

Resolution return Aspect Ratio

16:9

Backlight Technology W-LED / Full

Array Brightness (cd/m2) 350

Contrast Ratio 4000 : 1

Built in Speakers (W) 10W + 10W

Cabinet Colour Black

Options to enhance collaboration

There are many options available to suit you and your needs.
Some of these are listed below:

- Wireless Connectivity
- Media Players
- Camera
- Audio options
- Video conferencing packages



Digital Signage Stands



55" Digital Signage Stand - Portrait

55" Screen

Dimensions:

1037mm(W) x 355mm(D) x 2001mm(H)

Weight: 100kg

55" Digital Signage Stand - Landscape

55" Screen

Dimensions:

1568mm(W) x 374mm(D) x 1716mm(H)

Weight: 104kg

PNHW551

Panel Technology TFT LCD

Native Resolution 4K UHD

Diagonal Size (inches / cm) 55 / 138

Aspect Ratio 16:9

Backlight Technology W-LED / Full Array

Brightness (cd/m2) 350

Contrast Ratio 4000 : 1

Viewing Angle 178 / 178

Built in Speakers (W) 10W + 10W

Cabinet Colour Black



65" Digital Signage Stand - Portrait

65" Screen

Dimensions:

1161mm(W) x 444mm(D) x 2221mm(H)

Weight: 110kg

65" Digital Signage Stand - Landscape

65" Screen

Dimensions:

1785mm(W) x 374mm(D) x 1838mm(H)

Weight: 120kg

PNHW651

Panel Technology TFT LCD

Native Resolution 4K UHD

Diagonal Size (inches / cm) 65 / 163

Aspect Ratio 16:9

Backlight Technology W-LED / Full Array

Brightness (cd/m2) 350

Contrast Ratio 4000 : 1

Viewing Angle 178 / 178 Built in

Speakers (W) 10W + 10W

Cabinet Colour Black

Levigator Adjustable AV Stand

Levigator

Electronic Height adjustable screen trolley

Dimensions:

719(D) x 1030mm(W) X 1128-1758mm(H)

PN65HC1

Panel Technology TFT LCD

Native Resolution (Pixels) 3840 x 2160

Diagonal Size (inches / cm) 65/163.9

Aspect Ratio 16:9

Backlight Technology LED, edge lit

Brightness (cd/m2) 400

Contrast Ratio 4000:1

Built in Speakers (W) 10 + 10

Cabinet Colour Black

Fanless



Switch 45 Adjustable AV Stand

Switch 45

Height adjustable screen trolley

Rotates 45° into a touch screen table

Dimensions:

749(D) x 1100mm(W) X 1132-1792mm(H)

Height (at 45° position): 1102-1701mm

PN65TH1

Panel Technology LCD

Native Resolution 4K UHD

Diagonal Size (inches / cm) 65/163.9

Aspect Ratio 16:9

Backlight Technology LED, full array

Brightness (cd/m2) 350

Contrast Ratio 5000:1

Viewing Angle 178 x 178

Built in Speakers (W) 10 + 10

Cabinet Colour Black

Fanless



Technical Drawings

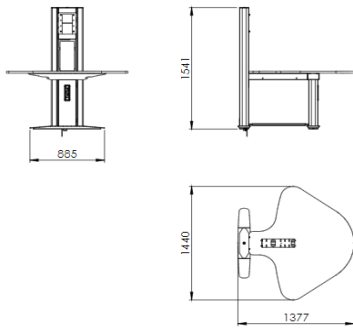

Collaborate 3 - AV Furniture

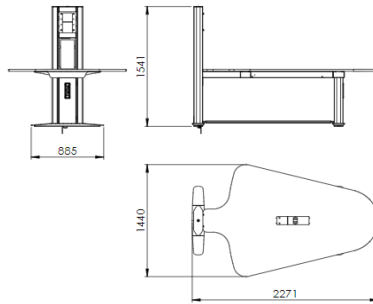

Collaborate 5 - AV Furniture

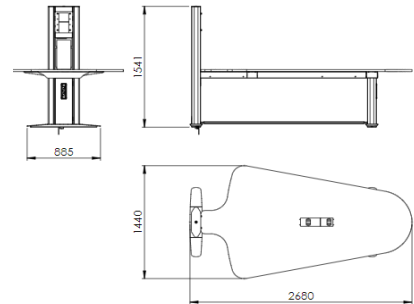

Collaborate 7 - AV Furniture

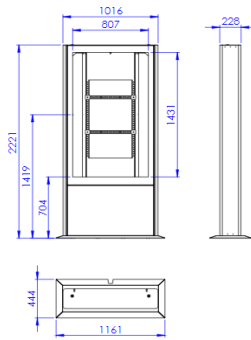

**Digital Signage Stand
65" Portrait**

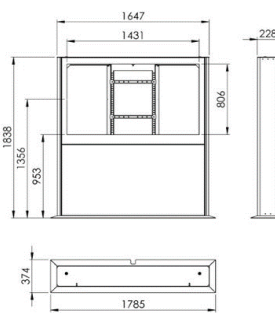

**Digital Signage Stand
65" Landscape**

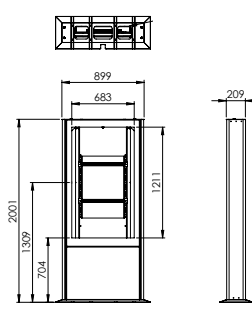

**Digital Signage Stand
55" Portrait**

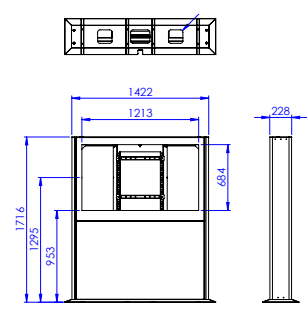

**Digital Signage Stand
55" Landscape**

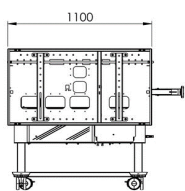

Switch 45 - Adjustable AV Stand

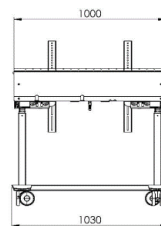
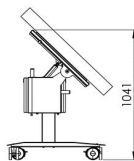
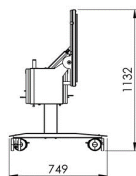

Levitator - Adjustable AV Stand

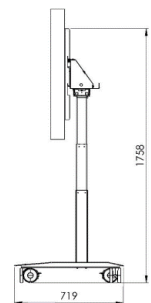
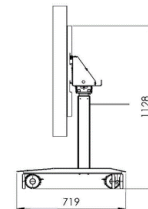

* Products in the Communicate and Collaborate range are not manufactured by Sharp. Sharp Business Systems UK (SBS UK) is the exclusive distributor of the product, but not the producer. The product has been designed and manufactured by a third-party which has provided SBS UK with detailed specifications.

Design and specifications are subject to change without prior notice. All information was correct at time of print. All other company names, product names and logotypes are trademarks or registered trademarks of their respective owners. ©Sharp Corporation October 2021. All trademarks acknowledged. E&O.